



secret jardin

# ASSEMBLY INSTRUCTIONS



## DARK PROPAGATOR R4.00

<b>ACCESSORIES .....</b>	<b>p.2</b>
<b>STRUCTURE ASSEMBLY .....</b>	<b>p.3</b>
<b>CANVAS &amp; ACCESSORIES ASSEMBLY .....</b>	<b>p.7</b>
<b>CONFIGURATION .....</b>	<b>p.8</b>



**DUCTING FLANGE Ø16**

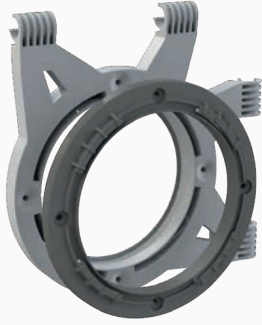

**Ducting Flange x2**



**Cutting Tool x1**



**Light Baffle x1**



**Connectors x1**  
100 - 125 - 150 mm

**CABLE FLANGE Ø7**



**Cable Flange x1**

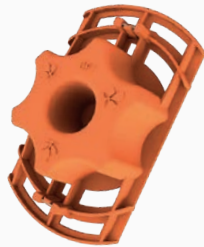

**Cutting Tool x1**

**GENERAL**



**WaterTray x1**



**CableIT**

DP60 x15  
DP90 x15  
DP120 x30

**METAL GRID**

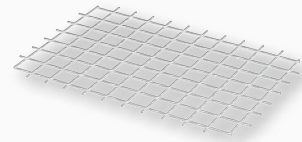

**Grid**

DP90 Option  
DP120 x12



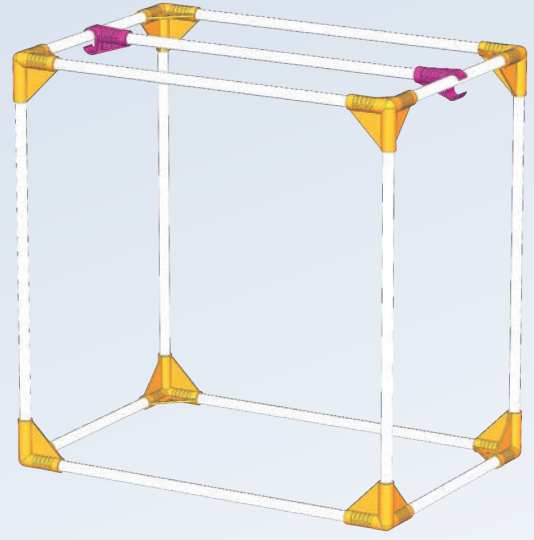
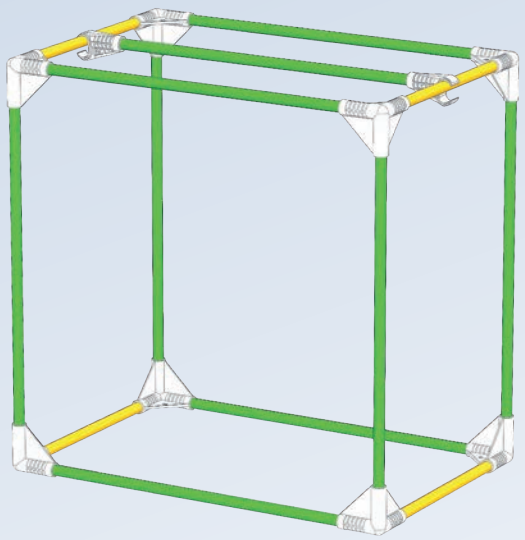

**Clips**

DP90 Option  
DP120 x48



9x T16-60  
4 x T16-40



8x C16-Y



2x C16-H

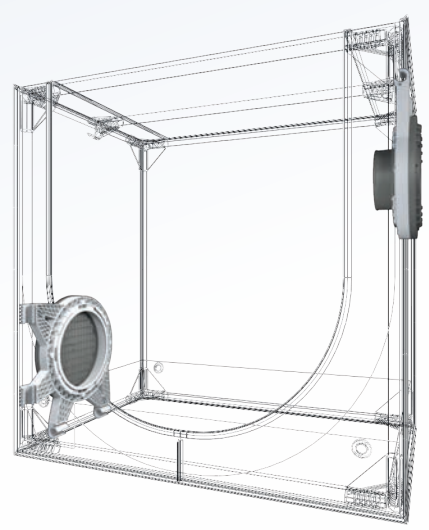

Canvas & accessories  
assembly p.7



**CONFIGURATION 1 : 1x FLOOR (100CM - 40")**

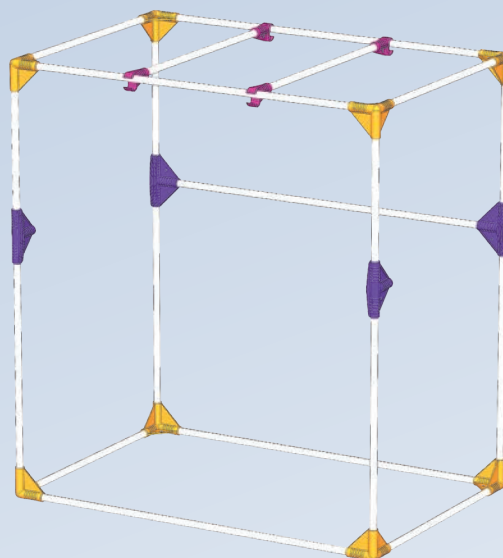
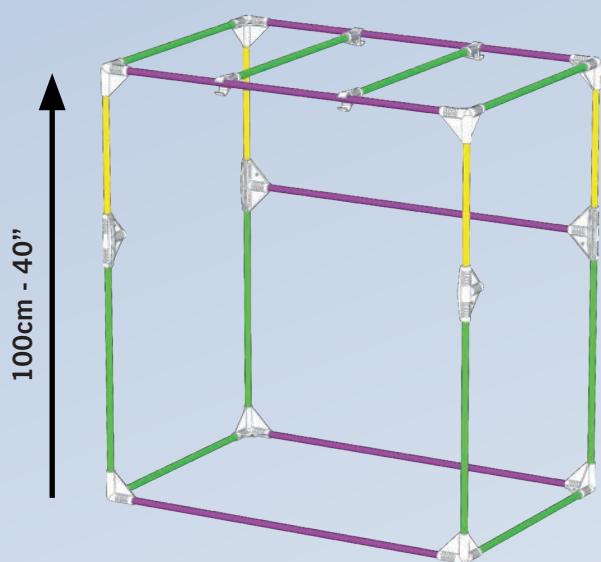

**CONFIGURATION 3 : 2x FLOORS (GRIDS SOLD ON OPTION)**

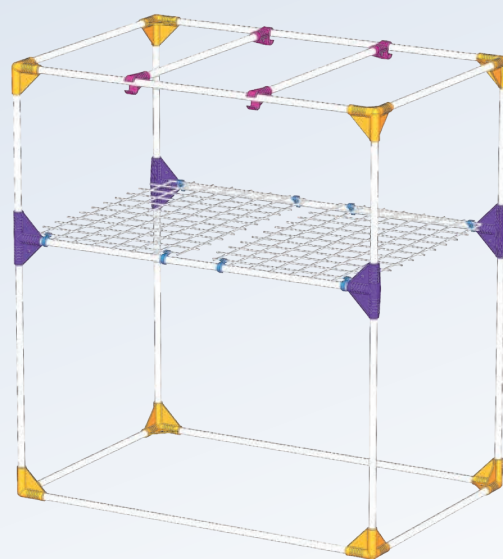
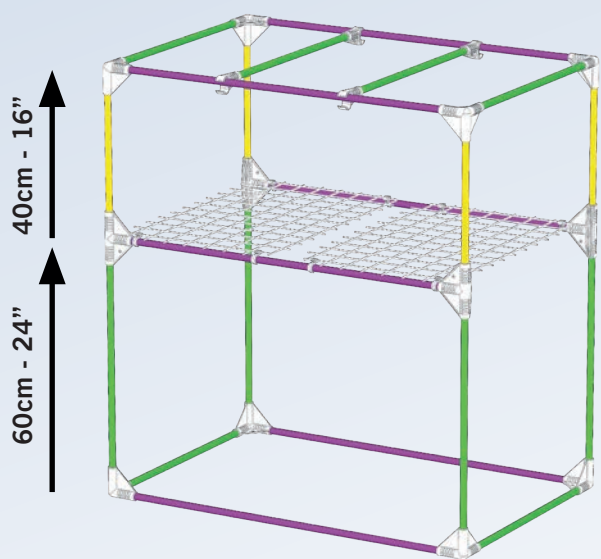

## CONFIGURATION 2 : 1X FLOOR (60CM - 24")

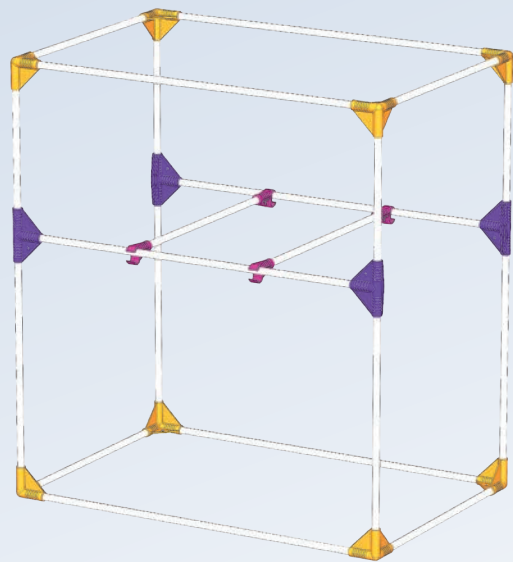
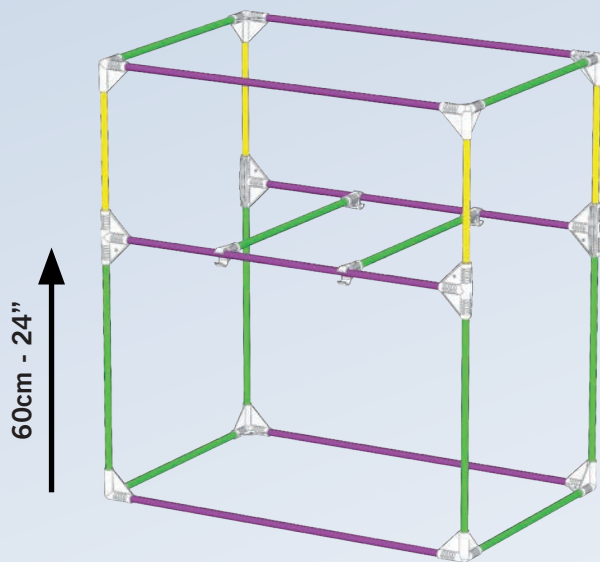

6 x T16-90

2+8 x T16-60

4 x T16-40

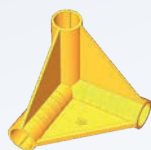

8x C16-Y



4x C16-T



4x C16-H

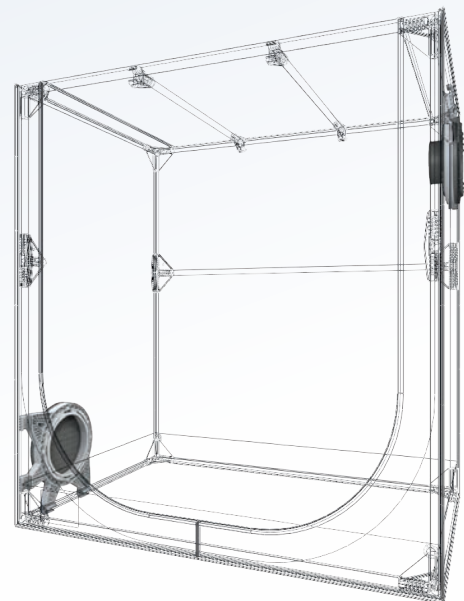

Canvas & accessories  
assembly p.7



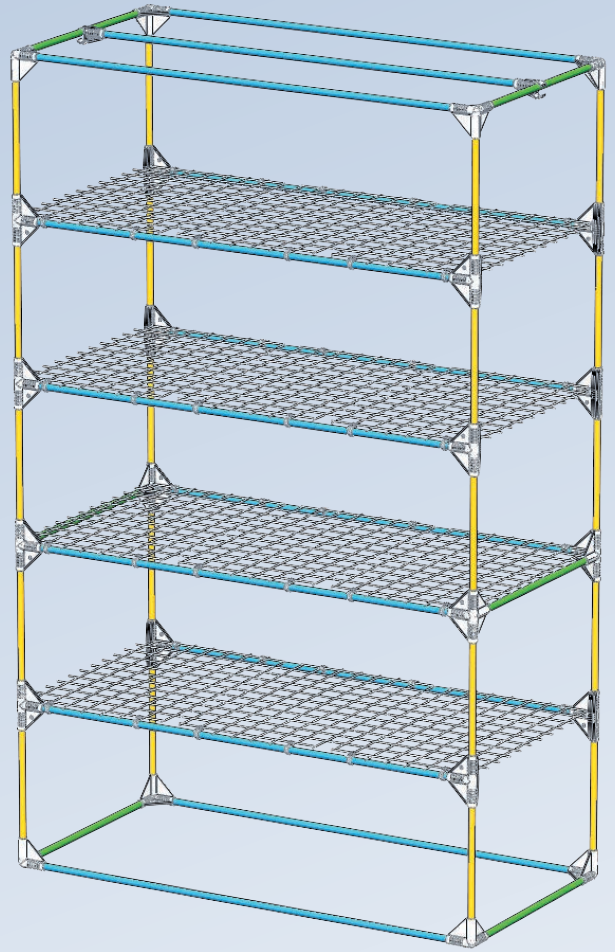
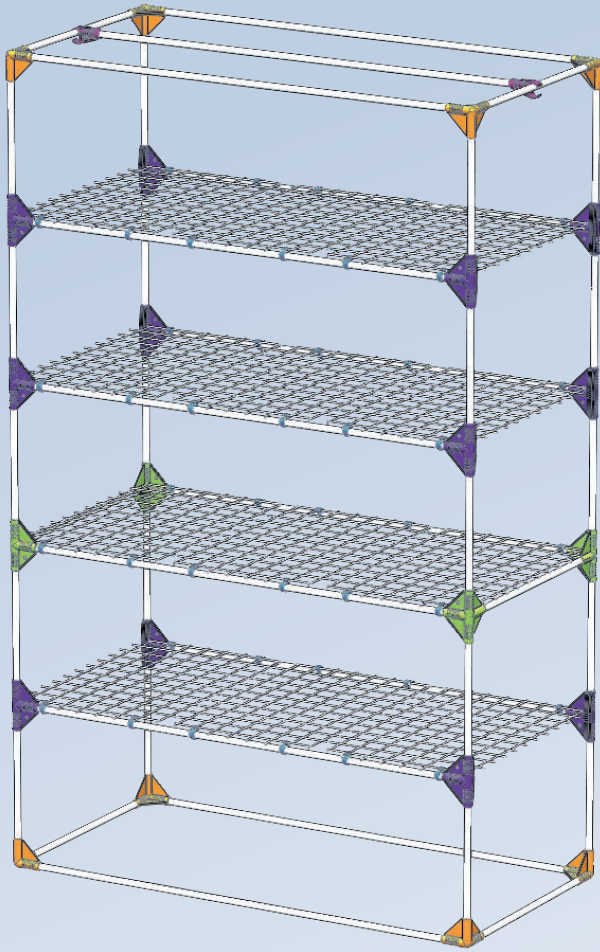

13x T16-120

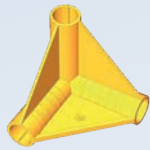

8x C16-Y



12x C16-T

6x T16-60

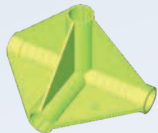

4x C16-K



48x Clips

20 x T16-40



2x C16-H

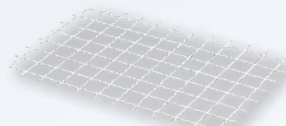

12x Grid6040



**Canvas & accessories  
assembly p.7**

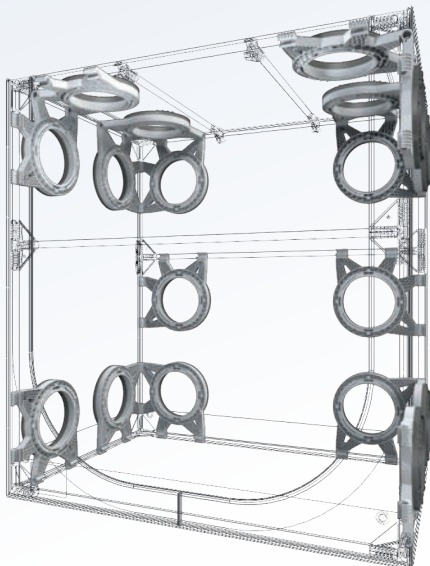
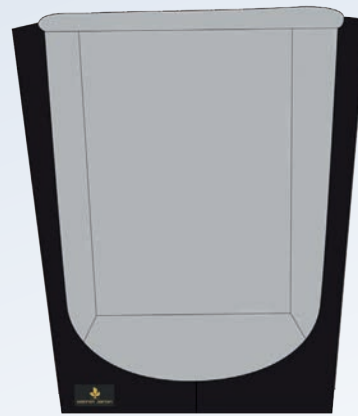
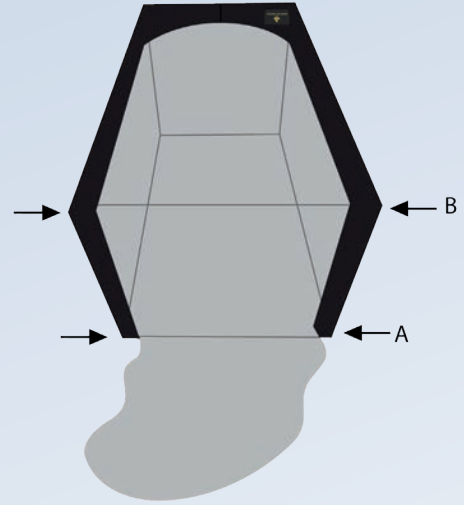
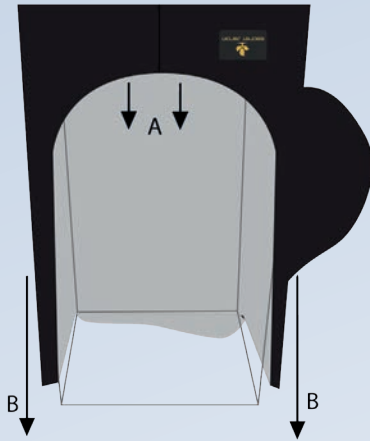

**DUCTING & CABLE FLANGES**

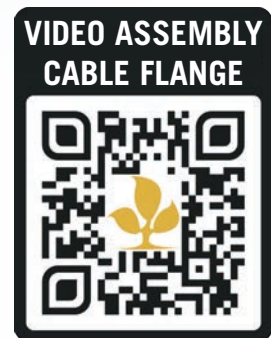

# METRIC

DARK PROPAGATION			WGT	HANDLING		LIGHTING	VOL	VENTILATION ADVISED			
REF	DESIGNATION	REV	Net kg	#	L cm	Weight Per Pole	Advised	HOT every 1-2 min		COLD every 2-4 min	
								Extraction	Intake	Extraction	Intake
DP60	Dark Propagator 60 x 40 x 60 cm	R4.00	3,3	1	60	10 kg	1 TLED26W	10 m3/h	-	5 m3/h	-
DP90	Dark Propagator 90 x 60 x 98 cm	R4.00	5,8	2	60	10 kg	2 TLED26W	30 m3/h	-	15 m3/h	-
DP120	Dark Propagator 120 x 60 x 190 cm	R4.00	19,8	1	120	10 kg	4 TLED42W	80 m3/h	-	40 m3/h	-

# IMPERIAL

DARK PROPAGATION			WGT	HANDLING		LIGHTING	VOL	VENTILATION ADVISED			
REF	DESIGNATION	REV	Net lb	#	L in	Weight Max/Pole	Advised	HOT every 1-2 min		COLD every 2-4 min	
								Extraction	Intake	Extraction	Intake
DP60	Dark Propagator 2' x 1 1/3' x 2'	R4.00	7,3	1	24	20 lb	1 TLED26W	5 cfm	-	3 cfm	-
DP90	Dark Propagator 3' x 2' x 3 1/3'	R4.00	12,8	2	24	20 lb	2 TLED26W	20 cfm	-	10 cfm	-
DP120	Dark Propagator 4' x 2' x 6 2/3'	R4.00	43,7	1	47	20 lb	4 TLED42W	45 cfm	-	22 cfm	-



info@secretjardin.com



SECRET JARDIN



www.secretjardin.com